

moving property

sa  Urban

p r o p e r t y

*Al Pri-Va*  
Private Country Estate

*The Pinnacle of secure estate living*



**Shaun Harrison**  
**082-9005819**

**Al Pri-Va** is an exclusive development that offers its residents an exceptional quality of life. The rear of the estate is dominated by a 16 hectare forest reserve.



The forest reserve is host to a wide variety of bird and animal species; including Loerie, Bushbuck, Velvet Monkey, and Wild Pig. Limited pathways through this forest reserve allow residents to experience nature on their own doorstep.

Each site offers unique ocean and panoramic landscape views. The Balinese design manual allows you to design your own Zimbali-type home.



The secure complex has a guarded gate house at the entrance and has an electrified perimeter fence for additional peace of mind.





Examples taken from an existing dwelling



The design principles are set out in the design manual and are intended to direct the development character of each individual erf to ensure a coherent, cohesive, and legible environment. It is not intended to restrict creativity, but rather to stimulate innovation and inventiveness within a framework that ensures sensitivity to the natural context of the development.



The intention is to create a suitable 'style' for the Al Pri-Va Country Estate. This style will be flexible but disciplined, promoting:

- Outdoor/indoor living
- Courtyards
- Harmony with the natural environment

While prohibiting:

- Overcrowding/overbuilding
- View obstruction
- Visually harsh materials/colours



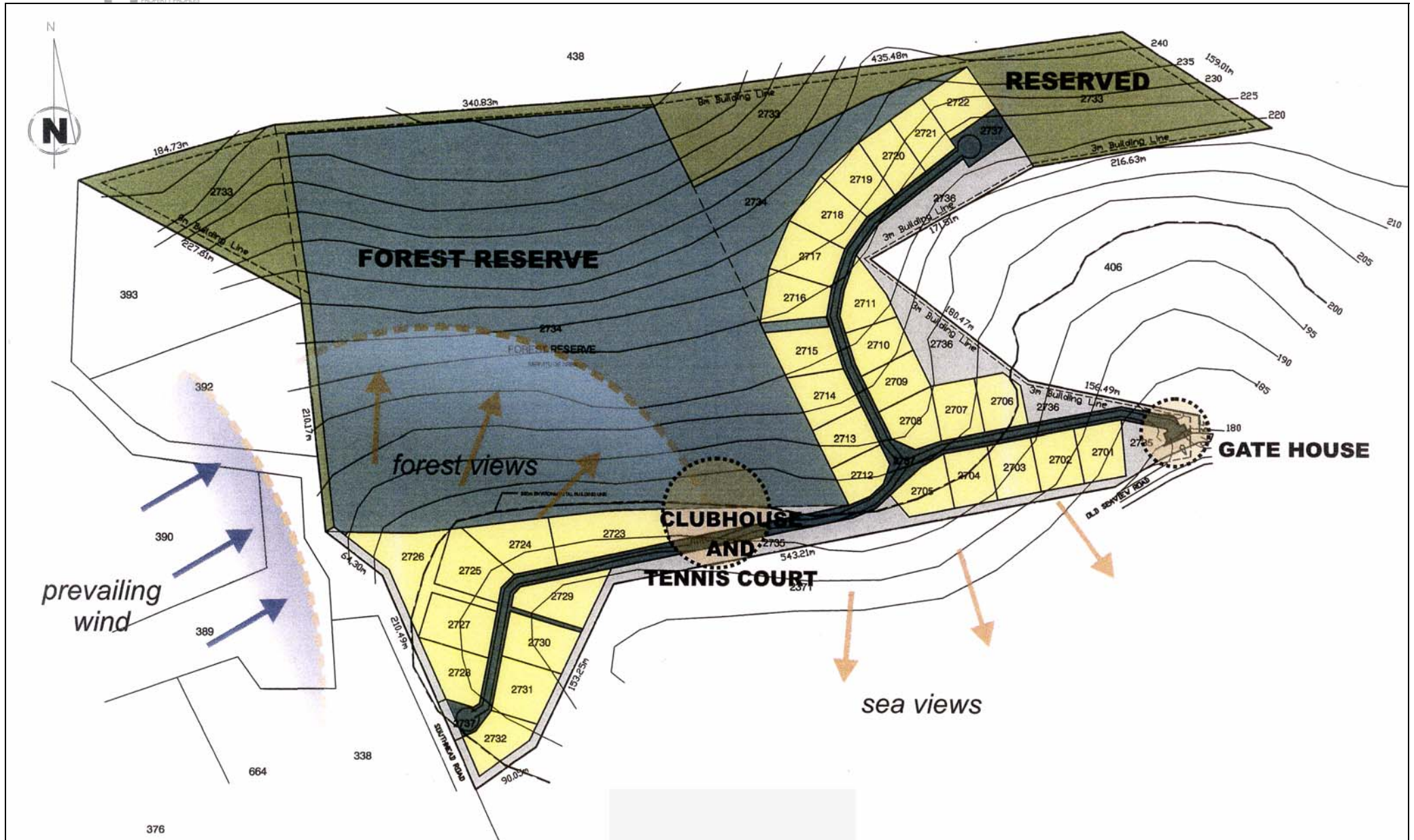



## CLUBHOUSE

### ASSOCIATED FACILITIES

The facilities associated with the clubhouse shall incorporate:

- Tennis court
- Swimming pool
- Natural watering hole

